

QuickFitting® Brass delivers superior performance, premium quality, significant value and a wide assortment of push-to-connect fittings that are safe for potable water applications.

### Features and Benefits

- Lead free materials - safe for potable water
- Fast, simple push-to-connect installation
- No tools, crimping, glue or flames needed
- Easy removal with our patented Slip Clip™ Release Tool
- Limited Lifetime Warranty (25 Years if Direct Burial)

### Materials

- Body Construction: Brass
- Sealing Element (O-ring): EPDM
- Grip Ring: AISI 301 Stainless Steel
- Tube Stiffener: Glass-filled Nylon

### Performance

- Operating Pressure (Max): 250 psi
- Test/Burst Pressure (Max): 600 psi\*  
(\*Standardized test requirement for ASSE 1061)
- Operating Temperature: 0°F - 200°F

### Pipe Compatibility

- Copper
- PEX
- CPVC

### Approved Applications (Services)

Approved for above and below ground applications (with silicone wrap), but requires approval from local inspector prior to installation due to codes and soil conditions.

- Potable Water Service
- Indoor/outdoor plumbing
- Heating Repair
- Marine Repair
- RV & Mobile Home Repair
- Irrigation

### Listings & Certificates

- ASSE 1061
- NSF/ANSI 61
- NSF/ANSI 372
- IAPMO Listed

Fitting Size	Insertion Depth
3/8"	3/4"
1/2"	1"
3/4"	1-3/16"
1"	1-3/16"

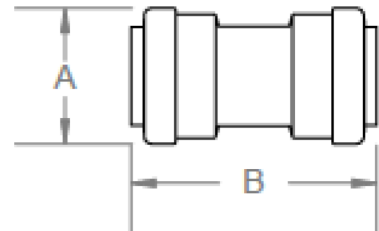

### Dimensional Data

Part No.	Size	A	B
LF801R	3/8"	0.87"	1.80"
LF811R	1/2"	1.06"	1.94"
LF821R	3/4"	1.35"	2.46"
LF831R	1"	1.75"	2.45"

Item # Submitted	
Job Name	
Date	
Engineer	
Contractor	
PO #	
Tag	

QuickFitting® Brass delivers superior performance, premium quality, significant value and a wide assortment of push-to-connect fittings that are safe for potable water applications.

### Features and Benefits

- Lead free materials - safe for potable water
- Fast, simple push-to-connect installation
- No tools, crimping, glue or flames needed
- Easy removal with our patented Slip Clip™ Release Tool
- Limited Lifetime Warranty (25 Years if Direct Burial)

### Materials

- Body Construction: Brass
- Sealing Element (O-ring): EPDM
- Grip Ring: AISI 301 Stainless Steel
- Tube Stiffener: Glass-filled Nylon

### Performance

- Operating Pressure (Max): 250 psi
- Test/Burst Pressure (Max): 600 psi
- Operating Temperature: 0°F - 200°F

### Pipe Compatibility

- Copper
- PEX
- CPVC
- Polybutylene

### Approved Applications (Services)

Approved for above and below ground applications (with silicone wrap), but requires approval from local inspector prior to installation due to codes and soil conditions.

- Potable Water Service
- Indoor/outdoor plumbing
- Heating Repair
- Marine Repair
- RV & Mobile Home Repair
- Irrigation

### Listings & Certificates

- ASSE 1061
- NSF/ANSI 61
- NSF/ANSI 372
- IAPMO Listed

Fitting Size	Insertion Depth
3/8"	3/4"
1/2"	1"
3/4"	1-3/16"
1"	1-3/16"

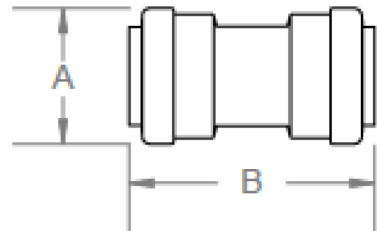

### Dimensional Data

Part No.	Size	A	B
LF811PBYR	1/2"	1.06"	1.94"
LF821PBYR	3/4"	1.35"	2.46"

Item # Submitted	
Job Name	
Date	
Engineer	
Contractor	
PO #	
Tag	

QuickFitting® Brass delivers superior performance, premium quality, significant value and a wide assortment of push-to-connect fittings that are safe for potable water applications.

### Features and Benefits

- Lead free materials - safe for potable water
- Fast, simple push-to-connect installation
- No tools, crimping, glue or flames needed
- Easy removal with our patented Slip Clip™ Release Tool
- Limited Lifetime Warranty (25 Years if Direct Burial)

### Materials

- Body Construction: Brass
- Sealing Element (O-ring): EPDM
- Grip Ring: AISI 301 Stainless Steel
- Tube Stiffener: Glass-filled Nylon

### Performance

- Operating Pressure (Max): 250 psi
- Test/Burst Pressure (Max): 600 psi\*  
(\*Standardized test requirement for ASSE 1061)
- Operating Temperature: 0°F - 200°F

### Pipe Compatibility

- Copper
- PEX
- CPVC

### Approved Applications (Services)

Approved for above and below ground applications (with silicone wrap), but requires approval from local inspector prior to installation due to codes and soil conditions.

- Potable Water Service
- Indoor/outdoor plumbing
- Heating Repair
- Marine Repair
- RV & Mobile Home Repair
- Irrigation

### Listings & Certificates

- ASSE 1061
- NSF/ANSI 61
- NSF/ANSI 372
- IAPMO Listed

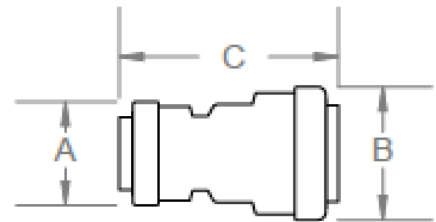
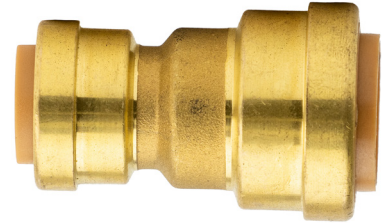

### Dimensional Data

Part No.	Size	A	B	C
LF8401R	3/8" x 1/2"	0.87"	1.05"	1.92"
LF841R	3/4" x 1/2"	1.06"	1.35"	2.23"
LF8413R	1" x 3/4"	1.35"	1.75"	2.49"

Fitting Size	Insertion Depth
3/8"	3/4"
1/2"	1"
3/4"	1-3/16"
1"	1-3/16"



Item # Submitted	
Job Name	
Date	
Engineer	
Contractor	
PO #	
Tag	

QuickFitting® Brass delivers superior performance, premium quality, significant value and a wide assortment of push-to-connect fittings that are safe for potable water applications.

### Features and Benefits

- Lead free materials - safe for potable water
- Fast, simple push-to-connect installation
- No tools, crimping, glue or flames needed
- Easy removal with our patented Slip Clip™ Release Tool
- Limited Lifetime Warranty (25 Years if Direct Burial)

### Materials

- Body Construction: Brass
- Sealing Element (O-ring): EPDM
- Grip Ring: AISI 301 Stainless Steel
- Tube Stiffener: Glass-filled Nylon

### Performance

- Operating Pressure (Max): 250 psi
- Test/Burst Pressure (Max): 600 psi\*  
(\*Standardized test requirement for ASSE 1061)
- Operating Temperature: 0°F - 200°F

### Pipe Compatibility

- Copper
- PEX
- CPVC

### Approved Applications (Services)

Approved for above and below ground applications (with silicone wrap), but requires approval from local inspector prior to installation due to codes and soil conditions.

- Potable Water Service
- Indoor/outdoor plumbing
- Heating Repair
- Marine Repair
- RV & Mobile Home Repair
- Irrigation

### Listings & Certificates

- ASSE 1061
- NSF/ANSI 61
- NSF/ANSI 372
- IAPMO Listed

Fitting Size	Insertion Depth
3/8"	3/4"
1/2"	1"
3/4"	1-3/16"
1"	1-3/16"

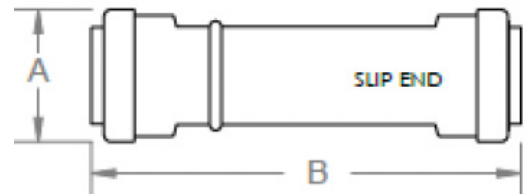

### Dimensional Data

Part No.	Size	A	B
LF817R	1/2"	1.06"	4.36"
LF827R	3/4"	1.35"	4.40"
LF837R	1"	1.75"	4.33"

Slip Repair Coupling includes Slip Clip™ Release Tool

Item # Submitted	
Job Name	
Date	
Engineer	
Contractor	
PO #	
Tag	

QuickFitting® Brass delivers superior performance, premium quality, significant value and a wide assortment of push-to-connect fittings that are safe for potable water applications.

### Features and Benefits

- Lead free materials - safe for potable water
- Fast, simple push-to-connect installation
- No tools, crimping, glue or flames needed
- Easy removal with our patented Slip Clip™ Release Tool
- Limited Lifetime Warranty (25 Years if Direct Burial)

### Materials

- Body Construction: Brass
- Sealing Element (O-ring): EPDM
- Grip Ring: AISI 301 Stainless Steel
- Tube Stiffener: Glass-filled Nylon

### Performance

- Operating Pressure (Max): 250 psi
- Test/Burst Pressure (Max): 600 psi\*  
(\*Standardized test requirement for ASSE 1061)
- Operating Temperature: 0°F - 200°F

### Pipe Compatibility

- Copper
- PEX
- CPVC

### Approved Applications (Services)

Approved for above and below ground applications (with silicone wrap), but requires approval from local inspector prior to installation due to codes and soil conditions.

- Potable Water Service
- Indoor/outdoor plumbing
- Heating Repair
- Marine Repair
- RV & Mobile Home Repair
- Irrigation

### Listings & Certificates

- ASSE 1061
- NSF/ANSI 61
- NSF/ANSI 372
- IAPMO Listed

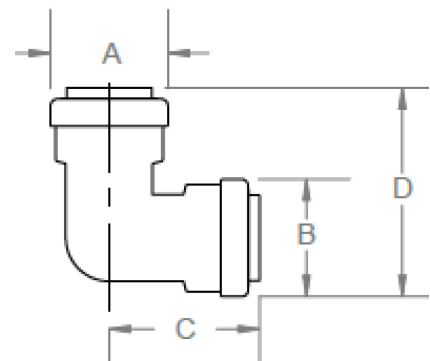

### Dimensional Data

Part No.	Size	A	B	C	D
LF803R	3/8"	0.87"	0.87"	0.61"	1.58"
LF813R	1/2"	1.06"	1.06"	1.32"	1.85"
LF823R	3/4"	1.35"	1.35"	1.73"	2.41"
LF833R	1"	1.75"	1.75"	1.88"	2.75"
LF843R	3/4" x 1/2"	1.35"	1.06"	1.49"	2.11"
LF8343R	1" x 3/4"	1.75"	1.35"	1.93"	2.46"
LF803FR	3/8" x 3/8" FNPT	0.87"	3/8" FNPT	1.26"	1.73"
LF813FR	1/2" x 1/2" FNPT	1.06"	1/2" FNPT	1.33"	1.76"
LF823FR	3/4" x 3/4" FNPT	1.35"	3/4" FNPT	1.43"	2.40"
LF803MR	3/8" x 3/8" MNPT	0.87"	3/8" MNPT	1.26"	1.58"
LF813MR	1/2" x 1/2" MNPT	1.06"	1/2" MNPT	1.33"	1.81"
LF823MR	3/4" x 3/4" MNPT	1.35"	3/4" MNPT	1.43"	2.39"

Fitting Size	Insertion Depth
3/8"	3/4"
1/2"	1"
3/4"	1-3/16"
1"	1-3/16"



Item # Submitted	
Job Name	
Date	
Engineer	
Contractor	
PO #	
Tag	

QuickFitting® Brass delivers superior performance, premium quality, significant value and a wide assortment of push-to-connect fittings that are safe for potable water applications.

### Features and Benefits

- Lead free materials - safe for potable water
- Fast, simple push-to-connect installation
- No tools, crimping, glue or flames needed
- Easy removal with our patented Slip Clip™ Release Tool
- Limited Lifetime Warranty (25 Years if Direct Burial)

### Materials

- Body Construction: Brass
- Sealing Element (O-ring): EPDM
- Grip Ring: AISI 301 Stainless Steel
- Tube Stiffener: Glass-filled Nylon

### Performance

- Operating Pressure (Max): 250 psi
- Test/Burst Pressure (Max): 600 psi\*  
(\*Standardized test requirement for ASSE 1061)
- Operating Temperature: 0°F - 200°F

### Pipe Compatibility

- Copper
- PEX
- CPVC

### Approved Applications (Services)

Approved for above and below ground applications (with silicone wrap), but requires approval from local inspector prior to installation due to codes and soil conditions.

- Potable Water Service
- Indoor/outdoor plumbing
- Heating Repair
- Marine Repair
- RV & Mobile Home Repair
- Irrigation

### Listings & Certificates

- ASSE 1061
- NSF/ANSI 61
- NSF/ANSI 372
- IAPMO Listed

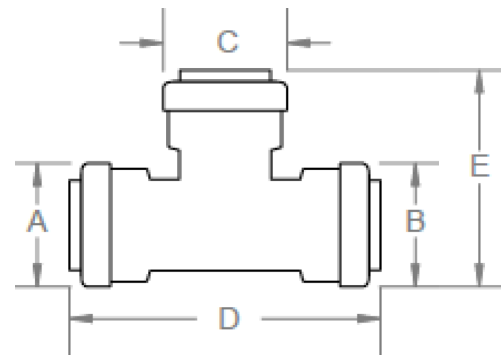

### Dimensional Data

Part No.	Size	A	B	C	D	E
LF804R	3/8"	0.87"	0.87"	0.87"	2.43"	1.65"
LF814R	1/2"	1.06"	1.06"	1.06"	2.69"	1.87"
LF824R	3/4"	1.35"	1.35"	1.35"	3.39"	2.37"
LF834R	1"	1.75"	1.75"	1.75"	3.72"	2.73"
LF8024R	3/8" x 3/8" x 1/2"	0.87"	0.87"	1.06"	2.43"	1.97"
LF8014R	1/2" x 1/2" x 3/8"	1.06"	1.06"	0.87"	2.79"	1.79"
LF815R	3/4" x 1/2" x 1/2"	1.35"	1.06"	1.06"	3.07"	1.87"
LF825R	3/4" x 1/2" x 3/4"	1.35"	1.06"	1.35"	3.23"	2.36"
LF844R	3/4" x 3/4" x 1/2"	1.35"	1.35"	1.06"	3.18"	2.12"
LF835R	1" x 1" x 3/4"	1.75"	1.75"	1.35"	3.42"	2.73"

Fitting Size	Insertion Depth
3/8"	3/4"
1/2"	1"
3/4"	1-3/16"
1"	1-3/16"



Item # Submitted	
Job Name	
Date	
Engineer	
Contractor	
PO #	
Tag	

QuickFitting® Brass delivers superior performance, premium quality, significant value and a wide assortment of push-to-connect fittings that are safe for potable water applications.

### Features and Benefits

- Lead free materials - safe for potable water
- Fast, simple push-to-connect installation
- No tools, crimping, glue or flames needed
- Easy removal with our patented Slip Clip™ Release Tool
- 7-Year Warranty

### Materials

- Body Construction: Brass
- Sealing Element (O-ring): EPDM
- Grip Ring: AISI 301 Stainless Steel
- Tube Stiffener: Glass-filled Nylon

### Performance

- Operating Pressure (Max): 250 psi
- Test/Burst Pressure (Max): 600 psi\*  
(\*Standardized test requirement for ASSE 1061)
- Operating Temperature: 0°F - 200°F

### Pipe Compatibility

- Copper
- PEX
- CPVC

### Approved Applications (Services)

Approved for above and below ground applications (with silicone wrap), but requires approval from local inspector prior to installation due to codes and soil conditions.

- Potable Water Service
- Indoor/outdoor plumbing
- Heating Repair
- Marine Repair
- RV & Mobile Home Repair
- Irrigation

### Listings & Certificates

- IAPMO/ANSI Z1157
- ASME A112.4.14/CSA B125.14
- NSF/ANSI 61
- NSF/ANSI 372
- IAPMO Listed

### Compliant with:

- ASSE 1061

Fitting Size	Insertion Depth
3/8"	3/4"
1/2"	1"
3/4"	1-3/16"
1"	1-3/16"

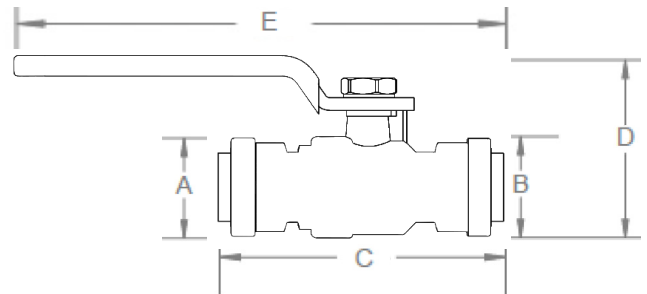
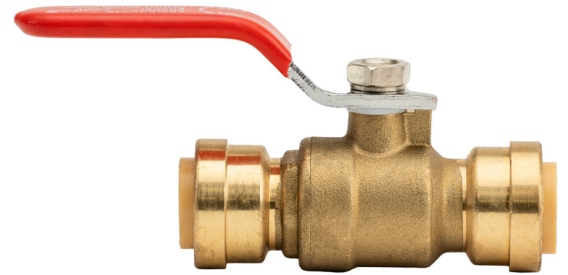

### Dimensional Data

Part No.	Size	A	B	C	D	E
LF902R	3/8"	0.87"	0.87"	2.69"	1.75"	4.38"
LF912R	1/2"	1.06"	1.06"	3.11"	1.97"	5.32"
LF922R	3/4"	1.35"	1.35"	3.80"	2.27"	5.70"
LF932R	1"	1.75"	1.75"	4.21"	2.87"	6.46"

Item # Submitted	
Job Name	
Date	
Engineer	
Contractor	
PO #	
Tag	

U25

QuickFitting® Brass delivers superior performance, premium quality, significant value and a wide assortment of push-to-connect fittings that are safe for potable water applications.

### Features and Benefits

- Lead free materials - safe for potable water
- Fast, simple push-to-connect installation
- No tools, crimping, glue or flames needed
- Easy removal with our patented Slip Clip™ Release Tool
- Limited Lifetime Warranty (25 Years if Direct Burial)

### Materials

- Body Construction: Brass
- Sealing Element (O-ring): EPDM
- Grip Ring: AISI 301 Stainless Steel
- Tube Stiffener: Glass-filled Nylon

### Performance

- Operating Pressure (Max): 250 psi
- Test/Burst Pressure (Max): 600 psi\*  
(\*Standardized test requirement for ASSE 1061)
- Operating Temperature: 0°F - 200°F

### Pipe Compatibility

- Copper
- PEX
- CPVC

### Approved Applications (Services)

Approved for above and below ground applications (with silicone wrap), but requires approval from local inspector prior to installation due to codes and soil conditions.

- Potable Water Service
- Indoor/outdoor plumbing
- Heating Repair
- Marine Repair
- RV & Mobile Home Repair
- Irrigation

### Listings & Certificates

- ASSE 1061
- NSF/ANSI 61
- NSF/ANSI 372
- IAPMO Listed

### Compliant with:

- ASTM B88
- ASME B1.20.1

Fitting Size	Insertion Depth
3/8"	3/4"
1/2"	1"
3/4"	1-3/16"
1"	1-3/16"

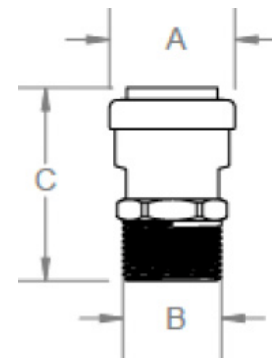

### Dimensional Data

Part No.	Size	A	B	C
LF802MR	3/8" x 3/8" MNPT	0.87"	3/8" MNPT	1.57"
LF812MR	1/2" x 1/2" MNPT	1.06"	1/2" MNPT	1.80"
LF822MR	3/4" x 3/4" MNPT	1.35"	3/4" MNPT	2.09"
LF832MR	1" x 1" MNPT	1.75"	1" MNPT	1.96"
LF840MR	3/8" x 1/2" MNPT	0.87"	1/2" MNPT	1.59"
LF842MR	1/2" x 3/4" MNPT	1.06"	3/4" MNPT	1.76"
LF8233MR	3/4" x 1" MNPT	1.35"	1" MNPT	2.07"
LF8322MR	1" x 3/4" MNPT	1.75"	3/4" MNPT	2.29"

Item # Submitted	
Job Name	
Date	
Engineer	
Contractor	
PO #	
Tag	

QuickFitting® Brass delivers superior performance, premium quality, significant value and a wide assortment of push-to-connect fittings that are safe for potable water applications.

### Features and Benefits

- Lead free materials - safe for potable water
- Fast, simple push-to-connect installation
- No tools, crimping, glue or flames needed
- Easy removal with our patented Slip Clip™ Release Tool
- Limited Lifetime Warranty (25 Years if Direct Burial)

### Materials

- Body Construction: Brass
- Sealing Element (O-ring): EPDM
- Grip Ring: AISI 301 Stainless Steel
- Tube Stiffener: Glass-filled Nylon

### Performance

- Operating Pressure (Max): 250 psi
- Test/Burst Pressure (Max): 600 psi\*  
(\*Standardized test requirement for ASSE 1061)
- Operating Temperature: 0°F - 200°F

### Pipe Compatibility

- Copper
- PEX
- CPVC

### Approved Applications (Services)

Approved for above and below ground applications (with silicone wrap), but requires approval from local inspector prior to installation due to codes and soil conditions.

- Potable Water Service
- Indoor/outdoor plumbing
- Heating Repair
- Marine Repair
- RV & Mobile Home Repair
- Irrigation

### Listings & Certificates

- ASSE 1061
- NSF/ANSI 61
- NSF/ANSI 372
- IAPMO Listed

### Compliant with:

- ASTM B88
- ASME B1.20.1

Fitting Size	Insertion Depth
3/8"	3/4"
1/2"	1"
3/4"	1-3/16"
1"	1-3/16"

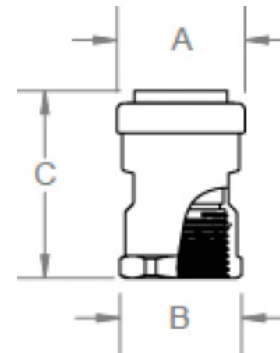

### Dimensional Data

Part No.	Size	A	B	C
LF802FR	3/8" x 3/8" FNPT	0.87"	3/8" FNPT	1.48"
LF812FR	1/2" x 1/2" FNPT	1.06"	1/2" FNPT	1.66"
LF822FR	3/4" x 3/4" FNPT	1.35"	3/4" FNPT	1.99"
LF832FR	1" x 1" FNPT	1.75"	1" FNPT	2.04"
LF840FR	3/8" x 1/2" FNPT	0.87"	1/2" FNPT	1.59"
LF842FR	1/2" x 3/4" FNPT	1.06"	3/4" FNPT	1.62"
LF8322FR	1" x 3/4" FNPT	1.75"	3/4" FNPT	2.02"

Item # Submitted	
Job Name	
Date	
Engineer	
Contractor	
PO #	
Tag	

QuickFitting® Brass delivers superior performance, premium quality, significant value and a wide assortment of push-to-connect fittings that are safe for potable water applications.

### Features and Benefits

- Lead free materials - safe for potable water
- Fast, simple push-to-connect installation
- No tools, crimping, glue or flames needed
- Easy removal with our patented Slip Clip™ Release Tool
- Limited Lifetime Warranty (25 Years if Direct Burial)

### Materials

- Body Construction: Brass
- Sealing Element (O-ring): EPDM
- Grip Ring: AISI 301 Stainless Steel
- Tube Stiffener: Glass-filled Nylon

### Performance

- Operating Pressure (Max): 250 psi
- Test/Burst Pressure (Max): 600 psi\*  
(\*Standardized test requirement for ASSE 1061)
- Operating Temperature: 0°F - 200°F

### Pipe Compatibility

- Copper
- PEX
- CPVC

### Approved Applications (Services)

Approved for above and below ground applications (with silicone wrap), but requires approval from local inspector prior to installation due to codes and soil conditions.

- Potable Water Service
- Indoor/outdoor plumbing
- Heating Repair
- Marine Repair
- RV & Mobile Home Repair
- Irrigation

### Listings & Certificates

- ASSE 1061
- NSF/ANSI 61
- NSF/ANSI 372
- IAPMO Listed

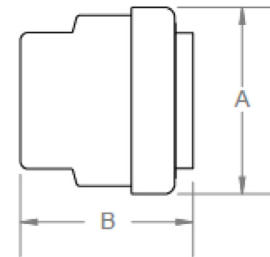
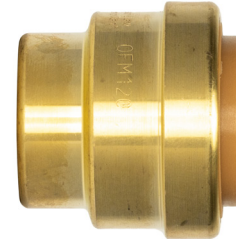

### Dimensional Data

Part No.	Size	A	B
LF806R	3/8"	0.87"	0.95"
LF816R	1/2"	1.06"	1.01"
LF826R	3/4"	1.35"	1.26"
LF836R	1"	1.75"	1.29"

Fitting Size	Insertion Depth
3/8"	3/4"
1/2"	1"
3/4"	1-3/16"
1"	1-3/16"



Item # Submitted	
Job Name	
Date	
Engineer	
Contractor	
PO #	
Tag	