

Check out Grainger's Newest Plumbing Fittings Supplier:

QUICKFITTING[®]

your

APPROVED VENDOR

in the **Push-To-Connect** category with over 50 fittings listed



WHY CHOOSE APPROVED VENDOR?

- ▶ **Better Performance**
With **3X the burst pressure** and **2.5X the tensile force** vs. the leading brand, you get a better performing product that you can rely on.
- ▶ **Better Price**
With **30-45% savings** vs. the leading brand, increase profitability and save money.

GRAINGER[®]

APPROVED VENDOR

FIND US ONLINE

- ▶ Visit Grainger.com
- ▶ Search for Category **Potable Water Push-to-Connect Tube Fittings**
- ▶ Select the Brand **APPROVED VENDOR**

The screenshot shows the Grainger website interface. At the top, there's a navigation bar with 'Catalog', 'Find A Branch', 'KeepStock', 'Help', and '1-800-GRAINGER'. On the right, there are links for 'Register' and 'Sign In'. Below the navigation bar is a search bar with the placeholder text 'Enter keyword, item, model or part #'. To the right of the search bar are links for 'Bulk Order', 'My Account', and a shopping cart icon. The main content area shows the breadcrumb trail: 'Product Categories / Pipe, Hose, Tube & Fittings / Tube & Tube Fittings / Tube Fittings / Push-to-Connect Tube Fittings / Potable Water Push-to-Connect Tube Fittings / APPROVED VENDOR Potable Water Push-to-Connect Tube Fittings'. There's a 'Search Feedback' button on the right. The left sidebar has a 'Brand' section with a list of brands: 'APPROVED VENDOR' (checked), 'JOHN GUEST', 'NIBCO', 'SHARKBITE', 'SHARKBITE MAX', and 'WATTS'. Below that is a 'Specific Fitting Shape' section with a list of shapes: '90° Drop Ear Elbow', '90° Elbow', '90° Elbow Adapter', 'Cap', 'Reducing Tee', 'Straight Adapter', and 'Straight Coupling'. The main content area is titled 'Potable Water Push-to-Connect Tube Fittings' and shows '52 products'. Below the title is a description: 'Potable water push-to-connect tube fittings are suitable for all drinking and potable water applications. These fittings, also called push fittings, connect tubing without the use of special tools, glue, soldering, or unions. Tubing is pushed into the fitting and held in place by a grab ring which disconnects the tubing for frequent changes.' There are two product images: 'Standard Brass Push-to-Connect Tube Fittings' and 'Stainless Steel Push-to-Connect Tube Fittings'. At the bottom, there's a 'Clear All' button and a 'Brand' filter set to 'APPROVED VENDOR'.

Review Product Offering
Select Brass or Stainless Steel

BENEFITS OF PUSH-TO-CONNECT

- ▶  NO FLAMES
- ▶  NO TOOLS NEEDED
- ▶  NO GLUE
- ▶  INSTALLS FAST



GRAINGER[®]

APPROVED VENDOR

MULTIPLE PLUMBING APPLICATIONS



PLUMBING



HEATING



OUTDOOR PLUMBING



MARINE



RV & MOBILE HOMES



IRRIGATION

EASY INSTALLATION



CUT IT



CLEAN IT



MARK IT



PUSH IT

QUICK RELEASE

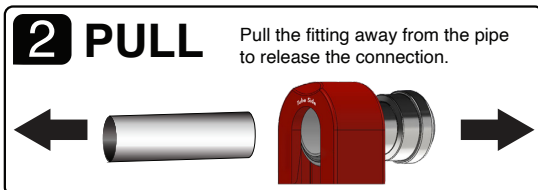
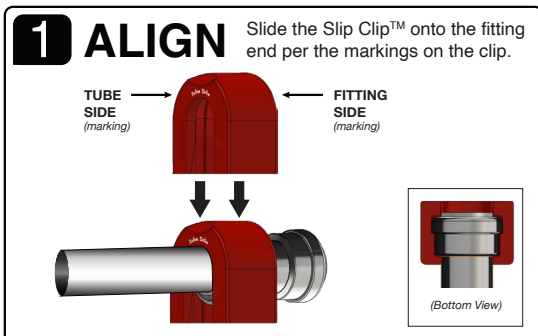

STAINLESS STEEL

Same great product
plus premium features



ZERO
LEAD



CORROSION
RESISTANT



NO WRAP
NEEDED

