

QuickFitting® Stainless Steel push-to-connect fittings deliver a patented design, superior sealing performance, and the highest corrosion resistance in both residential and commercial installations for joining of copper, PEX (with stiffener) and CPVC. Available in larger sizes (1-1/4" – 2").

Features and Benefits

- 100% lead free, corrosion-resistant Stainless Steel
- Fast, simple push-to-connect installation
- No tools, crimping, glue or flames needed
- Safe for potable water applications
- Compatible with Copper, CPVC, & PEX
- U.S. Manufactured Grip Ring Technology
- Approved for behind the wall or direct burial (no wrap required)
- Easy removal with our patented Slip Clip™ Release Tool
- 75-Year Warranty (25-Years if Direct Burial)

Specification Data

Materials

- Body Construction: AISI 304 Stainless Steel
- O-Ring: EPDM
- Grip Ring: AISI 301 Stainless Steel
- Tube Stiffener: Glass-filled Nylon (1/2"-1") or Copper (1-1/4"-2")

Performance

- Maximum Working Pressure: 250 psi
- Maximum Temperature: 200° F
- Applications: Indoor or outdoor plumbing, heating repair, marine repair, RV & mobile home repair, irrigation

Certifications and Listings

IAPMO listed as in compliance with the following standards:

- ASSE 1061-2015
- NSF/ANSI/CAN 61-2019
- NSF/ANSI/CAN 372-2020

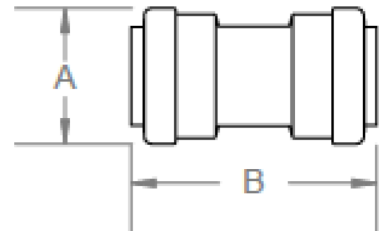
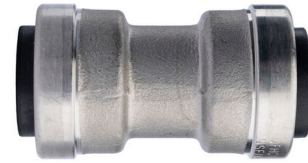

Dimensional Data

| Part No. | Size | A | B |
|----------|--------|-------|-------|
| SS811R | 1/2" | 1.06" | 1.94" |
| SS821R | 3/4" | 1.35" | 2.46" |
| SS831R | 1" | 1.75" | 2.45" |
| SS851R | 1-1/4" | 2.12" | 3.7" |
| SS861R | 1-1/2" | 2.57" | 4.25" |
| SS871R | 2" | 2.95" | 4.43" |

| Fitting Size | Insertion Depth |
|--------------|-----------------|
| 1/2" | 1" |
| 3/4" | 1-3/16" |
| 1" | 1-3/16" |
| 1-1/4" | 1-7/8" |
| 1-1/2" | 2-1/8" |
| 2" | 2-3/16" |

| | |
|------------------|--|
| Item # Submitted | |
| Job Name | |
| Date | |
| Engineer | |
| Contractor | |
| PO # | |
| Tag | |

QuickFitting® Stainless Steel push-to-connect fittings deliver a patented design, superior sealing performance, and the highest corrosion resistance in both residential and commercial installations for joining of copper, PEX (with stiffener) and CPVC. Available in larger sizes (1-1/4" – 2").

Features and Benefits

- 100% lead free, corrosion-resistant Stainless Steel
- Fast, simple push-to-connect installation
- No tools, crimping, glue or flames needed
- Safe for potable water applications
- Compatible with Copper, CPVC, & PEX
- U.S. Manufactured Grip Ring Technology
- Approved for behind the wall or direct burial (no wrap required)
- Easy removal with our patented Slip Clip™ Release Tool
- 75-Year Warranty (25-Years if Direct Burial)

Specification Data

Materials

- Body Construction: AISI 304 Stainless Steel
- O-Ring: EPDM
- Grip Ring: AISI 301 Stainless Steel
- Tube Stiffener: Glass-filled Nylon (1/2"-1") or Copper (1-1/4"-2")

Performance

- Maximum Working Pressure: 250 psi
- Maximum Temperature: 200° F
- Applications: Indoor or outdoor plumbing, heating repair, marine repair, RV & mobile home repair, irrigation

Certifications and Listings

IAPMO listed as in compliance with the following standards:

- ASSE 1061-2015
- NSF/ANSI/CAN 61-2019
- NSF/ANSI/CAN 372-2020

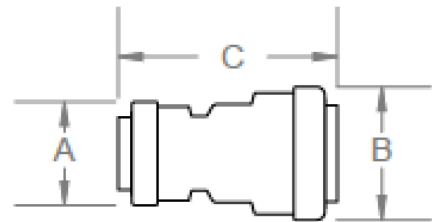

Dimensional Data

| Part No. | Size | A | B | C |
|----------|-------------|-------|-------|-------|
| SS841R | 3/4" x 1/2" | 1.06" | 1.35" | 2.23" |

| Fitting Size | Insertion Depth |
|--------------|-----------------|
| 1/2" | 1" |
| 3/4" | 1-3/16" |
| 1" | 1-3/16" |
| 1-1/4" | 1-7/8" |
| 1-1/2" | 2-1/8" |
| 2" | 2-3/16" |

| | |
|------------------|--|
| Item # Submitted | |
| Job Name | |
| Date | |
| Engineer | |
| Contractor | |
| PO # | |
| Tag | |

QuickFitting® Stainless Steel push-to-connect fittings deliver a patented design, superior sealing performance, and the highest corrosion resistance in both residential and commercial installations for joining of copper, PEX (with stiffener) and CPVC. Available in larger sizes (1-1/4" – 2").

Features and Benefits

- 100% lead free, corrosion-resistant Stainless Steel
- Fast, simple push-to-connect installation
- No tools, crimping, glue or flames needed
- Safe for potable water applications
- Compatible with Copper, CPVC, & PEX
- U.S. Manufactured Grip Ring Technology
- Approved for behind the wall or direct burial (no wrap required)
- Easy removal with our patented Slip Clip™ Release Tool
- 75-Year Warranty (25-Years if Direct Burial)

Specification Data

Materials

- Body Construction: AISI 304 Stainless Steel
- O-Ring: EPDM
- Grip Ring: AISI 301 Stainless Steel
- Tube Stiffener: Glass-filled Nylon (1/2"-1") or Copper (1-1/4"-2")

Performance

- Maximum Working Pressure: 250 psi
- Maximum Temperature: 200° F
- Applications: Indoor or outdoor plumbing, heating repair, marine repair, RV & mobile home repair, irrigation

Certifications and Listings

IAPMO listed as in compliance with the following standards:

- ASSE 1061-2015
- NSF/ANSI/CAN 61-2019
- NSF/ANSI/CAN 372-2020

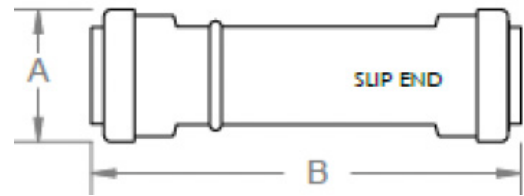

Dimensional Data

| Part No. | Size | A | B |
|----------|------|-------|-------|
| SS817R | 1/2" | 1.06" | 4.36" |
| SS827R | 3/4" | 1.35" | 4.4" |

Slip Repair Coupling includes Slip Clip™ Release Tool

| Fitting Size | Insertion Depth |
|--------------|-----------------|
| 1/2" | 1" |
| 3/4" | 1-3/16" |
| 1" | 1-3/16" |
| 1-1/4" | 1-7/8" |
| 1-1/2" | 2-1/8" |
| 2" | 2-3/16" |

| | |
|------------------|--|
| Item # Submitted | |
| Job Name | |
| Date | |
| Engineer | |
| Contractor | |
| PO # | |
| Tag | |

QuickFitting® Stainless Steel push-to-connect fittings deliver a patented design, superior sealing performance, and the highest corrosion resistance in both residential and commercial installations for joining of copper, PEX (with stiffener) and CPVC. Available in larger sizes (1-1/4" – 2").

Features and Benefits

- 100% lead free, corrosion-resistant Stainless Steel
- Fast, simple push-to-connect installation
- No tools, crimping, glue or flames needed
- Safe for potable water applications
- Compatible with Copper, CPVC, & PEX
- U.S. Manufactured Grip Ring Technology
- Approved for behind the wall or direct burial (no wrap required)
- Easy removal with our patented Slip Clip™ Release Tool
- 75-Year Warranty (25-Years if Direct Burial)

Specification Data

Materials

- Body Construction: AISI 304 Stainless Steel
- O-Ring: EPDM
- Grip Ring: AISI 301 Stainless Steel
- Tube Stiffener: Glass-filled Nylon (1/2"-1") or Copper (1-1/4"-2")

Performance

- Maximum Working Pressure: 250 psi
- Maximum Temperature: 200° F
- Applications: Indoor or outdoor plumbing, heating repair, marine repair, RV & mobile home repair, irrigation

Certifications and Listings

IAPMO listed as in compliance with the following standards:

- ASSE 1061-2015
- NSF/ANSI/CAN 61-2019
- NSF/ANSI/CAN 372-2020

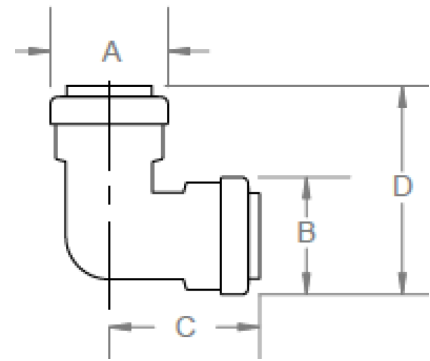

Dimensional Data

| Part No. | Size | A | B | C | D |
|----------|------------------|-------|-----------|-------|-------|
| SS813R | 1/2" | 1.06" | 1.06" | 1.32" | 1.85" |
| SS823R | 3/4" | 1.35" | 1.35" | 1.73" | 2.41" |
| SS833R | 1" | 1.75" | 1.75" | 1.88" | 2.75" |
| SS853R | 1-1/4" | 2.12" | 2.12" | 2.7" | 3.76" |
| SS863R | 1-1/2" | 2.57" | 2.57" | 3.05" | 4.34" |
| SS873R | 2" | 2.95" | 2.95" | 3.42" | 4.9" |
| SS813FR | 1/2" x 1/2" FNPT | 1.06" | 1/2" FNPT | 1.33" | 1.76" |
| SS823FR | 3/4" x 3/4" FNPT | 1.35" | 3/4" FNPT | 1.43" | 2.4" |
| SS813MR | 1/2" x 1/2" MNPT | 1.06" | 1/2" MNPT | 1.33" | 1.81" |
| SS823MR | 3/4" x 3/4" MNPT | 1.35" | 3/4" MNPT | 1.43" | 2.39" |
| SS843R | 3/4" x 1/2" | 1.35" | 1.06" | 1.49" | 2.11" |

| Fitting Size | Insertion Depth |
|--------------|-----------------|
| 1/2" | 1" |
| 3/4" | 1-3/16" |
| 1" | 1-3/16" |
| 1-1/4" | 1-7/8" |
| 1-1/2" | 2-1/8" |
| 2" | 2-3/16" |

| | |
|------------------|--|
| Item # Submitted | |
| Job Name | |
| Date | |
| Engineer | |
| Contractor | |
| PO # | |
| Tag | |

QuickFitting® Stainless Steel push-to-connect fittings deliver a patented design, superior sealing performance, and the highest corrosion resistance in both residential and commercial installations for joining of copper, PEX (with stiffener) and CPVC. Available in larger sizes (1-1/4" – 2").

Features and Benefits

- 100% lead free, corrosion-resistant Stainless Steel
- Fast, simple push-to-connect installation
- No tools, crimping, glue or flames needed
- Safe for potable water applications
- Compatible with Copper, CPVC, & PEX
- U.S. Manufactured Grip Ring Technology
- Approved for behind the wall or direct burial (no wrap required)
- Easy removal with our patented Slip Clip™ Release Tool
- 75-Year Warranty (25-Years if Direct Burial)

Specification Data

Materials

- Body Construction: AISI 304 Stainless Steel
- O-Ring: EPDM
- Grip Ring: AISI 301 Stainless Steel
- Tube Stiffener: Glass-filled Nylon (1/2"-1") or Copper (1-1/4"-2")

Performance

- Maximum Working Pressure: 250 psi
- Maximum Temperature: 200° F
- Applications: Indoor or outdoor plumbing, heating repair, marine repair, RV & mobile home repair, irrigation

Certifications and Listings

IAPMO listed as in compliance with the following standards:

- ASSE 1061-2015
- NSF/ANSI/CAN 61-2019
- NSF/ANSI/CAN 372-2020

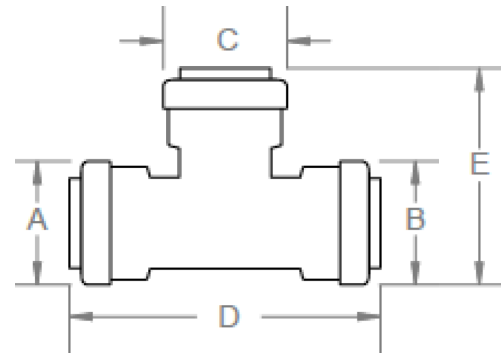

Dimensional Data

| Part No. | Size | A | B | C | D | E |
|----------|--------------------|-------|-------|-------|-------|-------|
| SS814R | 1/2" | 1.06" | 1.06" | 1.06" | 2.69" | 1.87" |
| SS824R | 3/4" | 1.35" | 1.35" | 1.35" | 3.39" | 2.37" |
| SS834R | 1" | 1.75" | 1.75" | 1.75" | 3.72" | 2.73" |
| SS854R | 1-1/4" | 2.12" | 2.12" | 2.12" | 5.26" | 3.69" |
| SS864R | 1-1/2" | 2.57" | 2.57" | 2.57" | 6.06" | 4.32" |
| SS874R | 2" | 2.95" | 2.95" | 2.95" | 6.72" | 4.84" |
| SS815R | 3/4" x 1/2" x 1/2" | 1.35" | 1.06" | 1.06" | 3.07" | 1.87" |
| SS825R | 3/4" x 1/2" x 3/4" | 1.35" | 1.06" | 1.35" | 3.23" | 2.36" |
| SS844R | 3/4" x 3/4" x 1/2" | 1.35" | 1.35" | 1.06" | 3.18" | 2.12" |
| SS835R | 1" x 1" x 3/4" | 1.75" | 1.75" | 1.35" | 3.42" | 2.73" |

| Fitting Size | Insertion Depth |
|--------------|-----------------|
| 1/2" | 1" |
| 3/4" | 1-3/16" |
| 1" | 1-3/16" |
| 1-1/4" | 1-7/8" |
| 1-1/2" | 2-1/8" |
| 2" | 2-3/16" |

| | |
|------------------|--|
| Item # Submitted | |
| Job Name | |
| Date | |
| Engineer | |
| Contractor | |
| PO # | |
| Tag | |

QuickFitting® Stainless Steel push-to-connect fittings deliver a patented design, superior sealing performance, and the highest corrosion resistance in both residential and commercial installations for joining of copper, PEX (with stiffener) and CPVC. Available in larger sizes (1-1/4" – 2").

Features and Benefits

- 100% lead free, corrosion-resistant Stainless Steel
- Fast, simple push-to-connect installation
- No tools, crimping, glue or flames needed
- Safe for potable water applications
- Compatible with Copper, CPVC, & PEX
- U.S. Manufactured Grip Ring Technology
- Approved for behind the wall or direct burial (no wrap required)
- Easy removal with our patented Slip Clip™ Release Tool
- 7-Year Warranty

Specification Data

Materials

- Body Construction: AISI 304 Stainless Steel
- O-Ring: EPDM
- Grip Ring: AISI 301 Stainless Steel
- Tube Stiffener: Glass-filled Nylon (1/2"-1") or Copper (1-1/4"-2")

Performance

- Maximum Working Pressure: 250 psi
- Maximum Temperature: 200° F
- Applications: Indoor or outdoor plumbing, heating repair, marine repair, RV & mobile home repair, irrigation

Certifications and Listings

IAPMO listed as in compliance with the following standards:

- ASSE 1061-2015
- NSF/ANSI/CAN 61-2019, NSF/ANSI/CAN 372-2020
- IAPMO/ANSI Z1157-2014e1 (R2019)

| Fitting Size | Insertion Depth |
|--------------|-----------------|
| 1/2" | 1" |
| 3/4" | 1-3/16" |
| 1" | 1-3/16" |
| 1-1/4" | 1-7/8" |
| 1-1/2" | 2-1/8" |
| 2" | 2-3/16" |

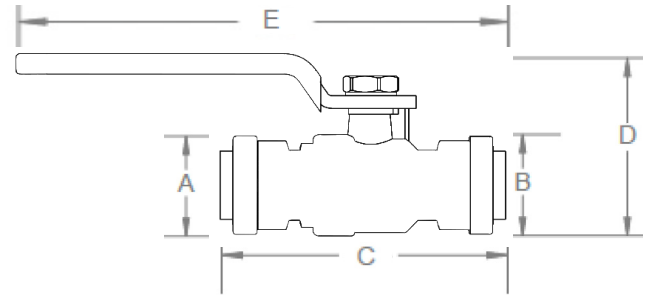
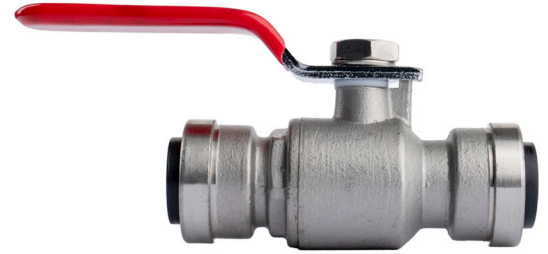

Dimensional Data

| Part No. | Size | A | B | C | D | E |
|----------|--------|-------|-------|-------|-------|--------|
| SS912R | 1/2" | 1.06" | 1.06" | 3.11" | 1.97" | 5.32" |
| SS922R | 3/4" | 1.35" | 1.35" | 3.80" | 2.27" | 5.70" |
| SS932R | 1" | 1.75" | 1.75" | 4.21" | 2.87" | 6.46" |
| SS952R | 1-1/4" | 2.12" | 2.12" | 5.82" | 3.76" | 7.67" |
| SS962R | 1-1/2" | 2.57" | 2.57" | 6.87" | 4.42" | 8.37" |
| SS972R | 2" | 3.22" | 3.22" | 7.47" | 5.23" | 10.06" |

| | |
|------------------|--|
| Item # Submitted | |
| Job Name | |
| Date | |
| Engineer | |
| Contractor | |
| PO # | |
| Tag | |

QuickFitting® Stainless Steel push-to-connect fittings deliver a patented design, superior sealing performance, and the highest corrosion resistance in both residential and commercial installations for joining of copper, PEX (with stiffener) and CPVC. Available in larger sizes (1-1/4" – 2").

Features and Benefits

- 100% lead free, corrosion-resistant Stainless Steel
- Fast, simple push-to-connect installation
- No tools, crimping, glue or flames needed
- Safe for potable water applications
- Compatible with Copper, CPVC, & PEX
- U.S. Manufactured Grip Ring Technology
- Approved for behind the wall or direct burial (no wrap required)
- Easy removal with our patented Slip Clip™ Release Tool
- 75-Year Warranty (25-Years if Direct Burial)

Specification Data

Materials

- Body Construction: AISI 304 Stainless Steel
- O-Ring: EPDM
- Grip Ring: AISI 301 Stainless Steel
- Tube Stiffener: Glass-filled Nylon (1/2"-1") or Copper (1-1/4"-2")

Performance

- Maximum Working Pressure: 250 psi
- Maximum Temperature: 200° F
- Applications: Indoor or outdoor plumbing, heating repair, marine repair, RV & mobile home repair, irrigation

Certifications and Listings

IAPMO listed as in compliance with the following standards:

- ASSE 1061-2015
- NSF/ANSI/CAN 61-2019
- NSF/ANSI/CAN 372-2020

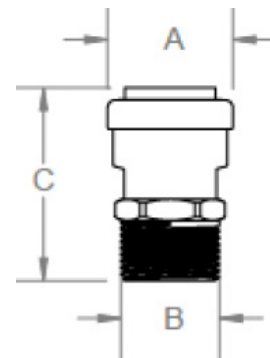

Dimensional Data

| Part No. | Size | A | B | C |
|----------|----------------------|-------|-------------|-------|
| SS812MR | 1/2" x 1/2" MNPT | 1.06" | 1/2" MNPT | 1.8" |
| SS822MR | 3/4" x 3/4" MNPT | 1.35" | 3/4" MNPT | 2.09" |
| SS832MR | 1" x 1" MNPT | 1.75" | 1" MNPT | 1.96" |
| SS852MR | 1-1/4" x 1-1/4" MNPT | 2.12" | 1-1/4" MNPT | 2.88" |
| SS862MR | 1-1/2" x 1-1/2" MNPT | 2.57" | 1-1/2" MNPT | 3.24" |
| SS872MR | 2" x 2" MNPT | 2.95" | 2" MNPT | 3.28" |

| Fitting Size | Insertion Depth |
|--------------|-----------------|
| 1/2" | 1" |
| 3/4" | 1-3/16" |
| 1" | 1-3/16" |
| 1-1/4" | 1-7/8" |
| 1-1/2" | 2-1/8" |
| 2" | 2-3/16" |

| | |
|-------------------------|--|
| Item # Submitted | |
| Job Name | |
| Date | |
| Engineer | |
| Contractor | |
| PO # | |
| Tag | |

QuickFitting® Stainless Steel push-to-connect fittings deliver a patented design, superior sealing performance, and the highest corrosion resistance in both residential and commercial installations for joining of copper, PEX (with stiffener) and CPVC. Available in larger sizes (1-1/4" – 2").

Features and Benefits

- 100% lead free, corrosion-resistant Stainless Steel
- Fast, simple push-to-connect installation
- No tools, crimping, glue or flames needed
- Safe for potable water applications
- Compatible with Copper, CPVC, & PEX
- U.S. Manufactured Grip Ring Technology
- Approved for behind the wall or direct burial (no wrap required)
- Easy removal with our patented Slip Clip™ Release Tool
- 75-Year Warranty (25-Years if Direct Burial)

Specification Data

Materials

- Body Construction: AISI 304 Stainless Steel
- O-Ring: EPDM
- Grip Ring: AISI 301 Stainless Steel
- Tube Stiffener: Glass-filled Nylon (1/2"-1") or Copper (1-1/4"-2")

Performance

- Maximum Working Pressure: 250 psi
- Maximum Temperature: 200° F
- Applications: Indoor or outdoor plumbing, heating repair, marine repair, RV & mobile home repair, irrigation

Certifications and Listings

IAPMO listed as in compliance with the following standards:

- ASSE 1061-2015
- NSF/ANSI/CAN 61-2019
- NSF/ANSI/CAN 372-2020

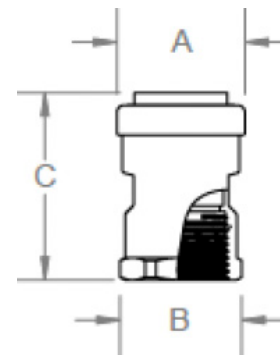

Dimensional Data

| Part No. | Size | A | B | C |
|----------|----------------------|-------|-------------|-------|
| SS812FR | 1/2" x 1/2" FNPT | 1.06" | 1/2" FNPT | 1.66" |
| SS822FR | 3/4" x 3/4" FNPT | 1.35" | 3/4" FNPT | 1.99" |
| SS832FR | 1" x 1" FNPT | 1.75" | 1" FNPT | 2.04" |
| SS852FR | 1-1/4" x 1-1/4" FNPT | 2.12" | 1-1/4" FNPT | 2.91" |
| SS862FR | 1-1/2" x 1-1/2" FNPT | 2.57" | 1-1/2" FNPT | 3.18" |
| SS872FR | 2" x 2" FNPT | 2.95" | 2" FNPT | 3.31" |
| SS842FR | 1/2" x 3/4" FNPT | 1.06" | 3/4" FNPT | 1.62" |

| Fitting Size | Insertion Depth |
|--------------|-----------------|
| 1/2" | 1" |
| 3/4" | 1-3/16" |
| 1" | 1-3/16" |
| 1-1/4" | 1-7/8" |
| 1-1/2" | 2-1/8" |
| 2" | 2-3/16" |

| | |
|------------------|--|
| Item # Submitted | |
| Job Name | |
| Date | |
| Engineer | |
| Contractor | |
| PO # | |
| Tag | |

QuickFitting® Stainless Steel push-to-connect fittings deliver a patented design, superior sealing performance, and the highest corrosion resistance in both residential and commercial installations for joining of copper, PEX (with stiffener) and CPVC. Available in larger sizes (1-1/4" – 2").

Features and Benefits

- 100% lead free, corrosion-resistant Stainless Steel
- Fast, simple push-to-connect installation
- No tools, crimping, glue or flames needed
- Safe for potable water applications
- Compatible with Copper, CPVC, & PEX
- U.S. Manufactured Grip Ring Technology
- Approved for behind the wall or direct burial (no wrap required)
- Easy removal with our patented Slip Clip™ Release Tool
- 75-Year Warranty (25-Years if Direct Burial)

Specification Data

Materials

- Body Construction: AISI 304 Stainless Steel
- O-Ring: EPDM
- Grip Ring: AISI 301 Stainless Steel
- Tube Stiffener: Glass-filled Nylon (1/2"-1") or Copper (1-1/4"-2")

Performance

- Maximum Working Pressure: 250 psi
- Maximum Temperature: 200° F
- Applications: Indoor or outdoor plumbing, heating repair, marine repair, RV & mobile home repair, irrigation

Certifications and Listings

IAPMO listed as in compliance with the following standards:

- ASSE 1061-2015
- NSF/ANSI/CAN 61-2019
- NSF/ANSI/CAN 372-2020

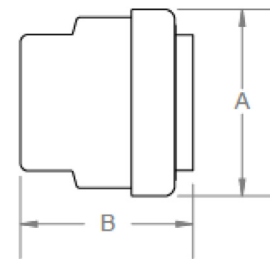

Dimensional Data

| Part No. | Size | A | B |
|----------|--------|-------|-------|
| SS816R | 1/2" | 1.06" | 1.01" |
| SS826R | 3/4" | 1.35" | 1.26" |
| SS836R | 1" | 1.75" | 1.29" |
| SS856R | 1-1/4" | 2.12" | 1.93" |
| SS866R | 1-1/2" | 2.57" | 2.2" |
| SS876R | 2" | 2.95" | 2.3" |

| Fitting Size | Insertion Depth |
|--------------|-----------------|
| 1/2" | 1" |
| 3/4" | 1-3/16" |
| 1" | 1-3/16" |
| 1-1/4" | 1-7/8" |
| 1-1/2" | 2-1/8" |
| 2" | 2-3/16" |

| | |
|------------------|--|
| Item # Submitted | |
| Job Name | |
| Date | |
| Engineer | |
| Contractor | |
| PO # | |
| Tag | |